



3 Peak View Close, Calver, Hope Valley, S32 3ZP



# 3 Peak View Close Calver

Asking Price

## £700,000

Set within a peaceful and picturesque location with beautiful views across the Derbyshire countryside to the rear, this immaculately presented four double bedroom home offers the perfect setting for family life, combining space, comfort and a true connection to the outdoors.

Located in the thriving village of Calver, the property enjoys all the benefits of a welcoming rural community while remaining highly convenient for everyday living. Surrounded by stunning countryside, Calver is ideal for families who enjoy walking, cycling and outdoor pursuits, with an abundance of nearby trails to explore. The village itself offers a range of amenities including local shops, a Post Office, a well-regarded primary school, traditional country inns and falls within the catchment area for Lady Manners School, making it particularly appealing for families. It is also well placed for commuting to major commercial centres.

The home has been thoughtfully designed and finished to a high standard throughout, with a light and airy feel and an excellent layout suited to modern family living. The accommodation includes a welcoming entrance hallway, a versatile study or family room and a dual aspect sitting room featuring a log burning stove, perfect for cosy evenings. The heart of the home is an impressive open plan dining kitchen, fitted with a comprehensive range of units and integrated appliances, complemented by built-in storage, a utility area and a WC, creating a practical and sociable space for family life and entertaining.

Upstairs, the first floor landing leads to four well-proportioned double bedrooms, one of which benefits from an en-suite shower room, alongside a stylish family bathroom.

Externally, the property is accessed via a private road leading to a single garage and off-road parking, complete with an electric charging point. The mature, well-stocked gardens wrap around the property, featuring planted beds, borders and seating terraces.



- A Spacious & Beautifully Presented Family Home
- Easy Commutable Distance Of Major Commercial Centres
- Local Primary School & Within Lady Manners School Catchment
- Garage & Off Road Parking
- Attractive Rear Garden Adjoining Open Countryside
- Direct Access To Many Local Walks & Outdoor Pursuits
- Excellent Village Shops Post Office & Amenities
- Separate Home Office
- EPC: C
- Viewings: Hathersage Office





### 3 Peak View Close

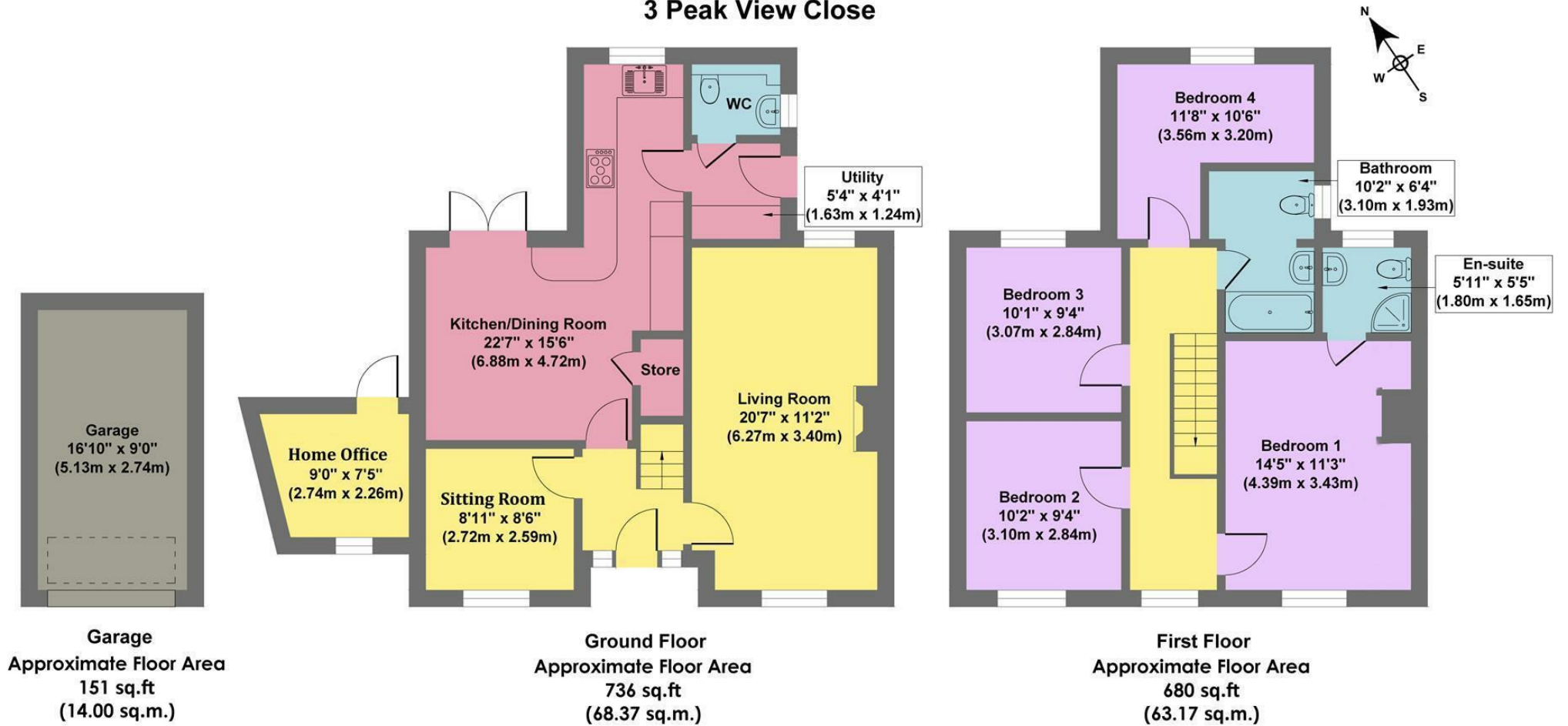

**Approx. Gross Internal Floor Area 1567 sq.ft / 145.54 sq.m**

Illustration for identification purposes only, measurements are approximate, not to scale

While we endeavour to make our sales particulars fair, accurate and reliable, they are only a general guide to the property and, accordingly, if there is any point, which is of particular importance to you, please contact the relevant office. The Agents have not tested any apparatus, equipment, fittings or services and so cannot verify they are in working order. The buyer is advised to obtain verification. Please note all the measurement details are approximate and should not be relied upon as exact. All plans, floor plans and maps are for guidance purposes only and are not to scale. Under no circumstances should they be relied upon as exact or for use in planning carpets and other such fixtures, fittings or furnishings. YOUR HOME IS AT RISK IF YOU DO NOT KEEP UP REPAYMENTS ON A MORTGAGE OR OTHER LOAN SECURED ON IT. 'A Life Assurance policy may be requested.' 'Written Quotations of credit terms available on request.'

Banner Cross  
T: 0114 268 3241  
E: [bannercross@saxtonmee.co.uk](mailto:bannercross@saxtonmee.co.uk)  
[www.saxtonmee.co.uk](http://www.saxtonmee.co.uk)

Hathersage  
T: 01433 650009  
E: [hathersage@saxtonmee.co.uk](mailto:hathersage@saxtonmee.co.uk)

Bakewell  
T: 01629 815307  
E: [bakewell@saxtonmee.co.uk](mailto:bakewell@saxtonmee.co.uk)

Matlock  
T: 01629 828250  
E: [matlock@saxtonmee.co.uk](mailto:matlock@saxtonmee.co.uk)

